

Taro Tay TIN-HT

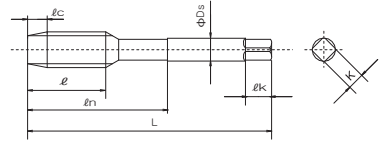

Unit:mm

EDP NO.	Thread Size	TAPLimit	ϵc	L	ϵ	ϕr_n	$\frac{1}{4} \times \frac{1}{16} D_s$	Flutes	External Centre	Stock
14700	M 2 × 0.4	OH1	5P	40	12	-	3	3		
14701			1.5P							
14702	M 2.3 × 0.4	OH1	5P	42	13	-	3	3		
14703			1.5P							
14704	M 2.5 × 0.45	OH1	5P	44	14	-	3	3		
14705			1.5P							
14706	M 2.6 × 0.45	OH1	5P	44	14	-	3	3		
14707			1.5P							
14708	M 3 × 0.5	OH1	5P	46	11	19	4	3		
14709			1.5P							
14774	M 3.5 × 0.6	OH2	5P	48	13	20	4	3		
14775			1.5P							
14710	M 4 × 0.7	OH2	5P	52	13	21	5	3		
14711			1.5P							
14712	M 5 × 0.8	OH2	5P	60	16	24	5.5	3		
14713			1.5P							
14714	M 6 × 1	OH2	5P	62	19	29	6	3		
14715			1.5P							
14718	M 8 × 1.25	OH2	5P	70	22	37	6.2	3	D	
14719			1.5P							
14722	M 10 × 1.5	OH3	5P	75	24	41	7	3	D	
14723			1.5P							
14724	M 10 × 1.25	OH2	5P	75	24	41	7	3	D	
14725			1.5P							
14728	M 12 × 1.75	OH3	5P	82	29	48	8.5	3	D	
14729			1.5P							
14730	M 12 × 1.5	OH3	5P	82	29	48	8.5	3	D	
14731			1.5P							
14732	M 12 × 1.25	OH2	5P	82	29	48	8.5	3	D	
14733			1.5P							
14736	M14 × 2	OH3	5P	88	30	48	10.5	3	D	
14737			1.5P							
14738	M 14 × 1.5	OH3	5P	88	30	48	10.5	3	D	
14739			1.5P							
14742	M16 × 2	OH3	5P	95	32	52	12.5	3	D	
14743			1.5P							
14744	M 16 × 1.5	OH3	5P	95	32	52	12.5	3	D	

No. EDP NO.	Thread Size	TAPLimit	ϵc	L	ϵ	ϕr_n	$\frac{1}{4} \times \frac{1}{16} D_s$	Flutes	External Centre	Stock
14745	M16 × 1.5	OH3	1.5P	95	32	52	12.5	3		-
14748	M18 × 2.5		5P	100	37	55	14	3		-
14749		1.5P								-
14750	M18 × 1.5	OH3	5P	100	37	55	14	3		-
14751			1.5P							
14754	M20 × 2.5	OH3	5P	105	37	58	15	3		-
14755			1.5P							
14756	M20 × 1.5	OH3	5P	105	37	58	15	3		-
14757			1.5P							
14760	M22 × 2.5	OH3	5P	115	38	63	17	3		-
14761			1.5P							
14762	M22 × 1.5	OH3	5P	115	38	63	17	3		-
14763			1.5P							
14766	M24 × 3	OH3	5P	120	45	66	19	3		-
14767			1.5P							
14768	M24 × 1.5	OH3	5P	120	45	66	19	3		-
14769			1.5P							
14780	M27 × 3	OH3	5P	130	45	71	20	3		-
14781			1.5P							
14782	M27 × 1.5	OH3	5P	130	45	71	20	3		-
14783			1.5P							
14784	M30 × 3.5	OH3	5P	135	48	74	23	3		-
14785			1.5P							
14786	M30 × 1.5	OH3	5P	135	48	74	23	3		-
14787			1.5P							
14788	M33 × 3.5	OH3	5P	145	51	77	25	3		-
14789			1.5P							
14790	M33 × 1.5	OH3	5P	110	37	47	25	3		-
14791			1.5P							
14792	M36 × 4	OH4	5P	155	57	82	28	3		-
14793			1.5P							
14794	M36 × 1.5	OH3	5P	110	39	49	28	3		-
14795			1.5P							
14796	M42 × 4.5	OH4	5P	175	60	93	32	3		-
14797			1.5P							
14798	M42 × 1.5	OH3	5P	120	39	49	32	3		-
14799			1.5P							

Low Carbon Steels	Medium Carbon Steels	High Carbon Steels	Alloy Steels	Hardened Steels			Stainless Steels	Tool Steels	Cast Steels	Cast Iron	Ductile Cast Iron	Copper	Brass	Brass Casting	Bronze	Aluminum Rolled	Aluminum Alloy Casting	Magnesium Alloy Casting	Zinc Alloy Casting	Titanium Alloys	Nickel Alloys	Thermo Setting Plastic	Thermo Plastic
C ~0.25%	C0.25% ~0.45%	C 0.45%~	SCM	25~45 HRC	45~55 HRC	50~60 HRC	SUS	SKD	SC	FC	FCD	Cu	Bs	BsC	PB	AL	AC,ADC	MC	ZDC				
○	○	○	○	○									○	○	○	○	○	○	○				

○: Good